



# Buckby Cycle Stand Galvanised, Galvanised & Colour or Stainless



The Buckby Cycle Stand is a shaped tubular cycle stand. The design allows the frame of the bicycle to be secured by the users own security lock. The Buckby Cycle Stand is suitable for securing two bicycles. The Buckby Cycle Stand is available in galvanised steel, Grade 304 and Grade 316 Stainless Steel, with ragged feet for casting into new concrete or flanged feet for bolting to an existing surface.

The practical and durable nature of the Buckby Cycle Stand stand ensures that the stand will complement any environment and offers an aesthetically pleasing alternative to the Sheffield Cycle Stand.

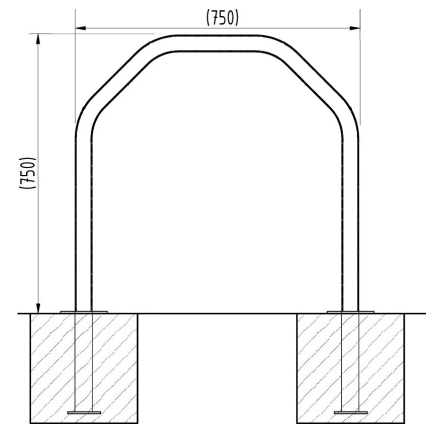

<u>Part Number</u>	<u>Description</u>	<u>Weight (kg)</u>
138 515 185	Galvanised - Concrete In	9kg
138 515 180	Galvanised - Bolt Down	8kg
138 515 186	Galvanised & Black - Concrete In	9kg
138 515 181	Galvanised & Black - Bolt Down	8kg
138 515 187	Galvanised & Colour - Concrete In	9kg
138 515 182	Galvanised & Colour - Bolt Down	8kg
138 515 184	Stainless Steel - 304 - Concrete In	9kg
138 515 189	Stainless Steel - 304 - Bolt down	8kg
138 515 188	Stainless Steel - 316 - Concrete In	9kg
138 515 183	Stainless Steel - 316 - Bolt Down	8kg

## Product details

- 48mm diameter tube
- 750mm x 750mm (height x length)
- Concrete in 300mm (below ground)
- Round flange plate – 133mm x 5mm
- Each stand requires 6 bolts

## Installation & use

Bolt down to a suitable concrete surface.  
Telescopic, removable and concrete in are supplied with welded fixing spikes to ensure firm ground anchorage into concrete.  
Telescopic, removable and concrete in require a suitable excavated hole for installing into concrete.  
Products are guaranteed for 12 months (if installed and used correctly).



[www.autopa.co.uk](http://www.autopa.co.uk)  
+44 (0)1788 550556

AUTOPA Limited  
Cottage Leap, Rugby, Warwickshire CV21 3XP

